

# XSD softpressure® patented – spare part list

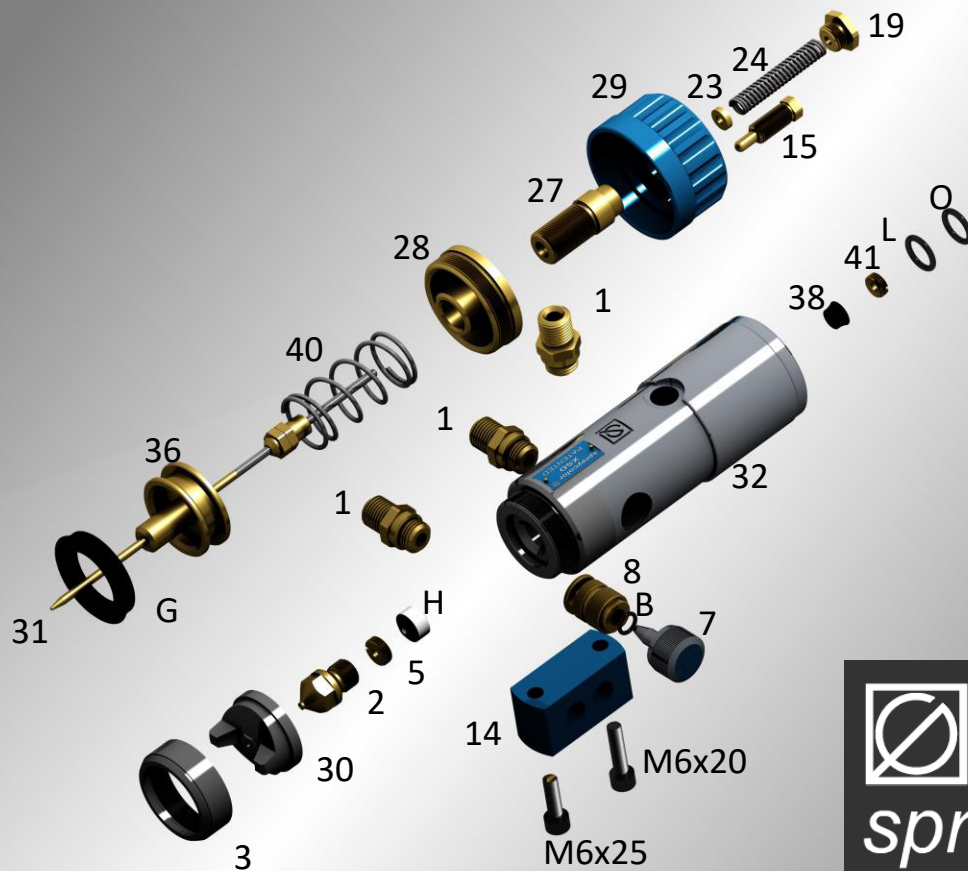

**spraycolor®**  
since 1968  
a family tradition

SCREF	1	pipe fitting G 1/4	SCREF29/C	complete regulation handwell	
SCREF	2	PVD coated nozzle	SCREF	30	head
SCREF	3	nut for head	SCREF	31	PVD coated needle
SCREF	5	gasket screw cap	SCREF	32	gun casing
SCREF	7	air regulation screw	SCREF	36	piston
SCREF	8	air regulation valve	SCREF	38	gasket
SCREF	14	support block	SCREF	40	stainless steel piston spring
SCREF	15	release pivot handwell	SCREF	41	screw cap gasket
SCREF	19	cap spring container	SCREF	B	O-ring gasket
SCREF	23	washer	SCREF	G	gasket
SCREF	24	stainless steel needle spring	SCREF	H	gasket
SCREF	27	spring container	SCREF	H/2	PTFE special gasket
SCREF	28	cylinder cap	SCREF	L	O-ring gasket
SCREF	29	regulation handwell	SCREF	O	O-ring gasket



**XSD**

DATASHEET

- softpressure® -

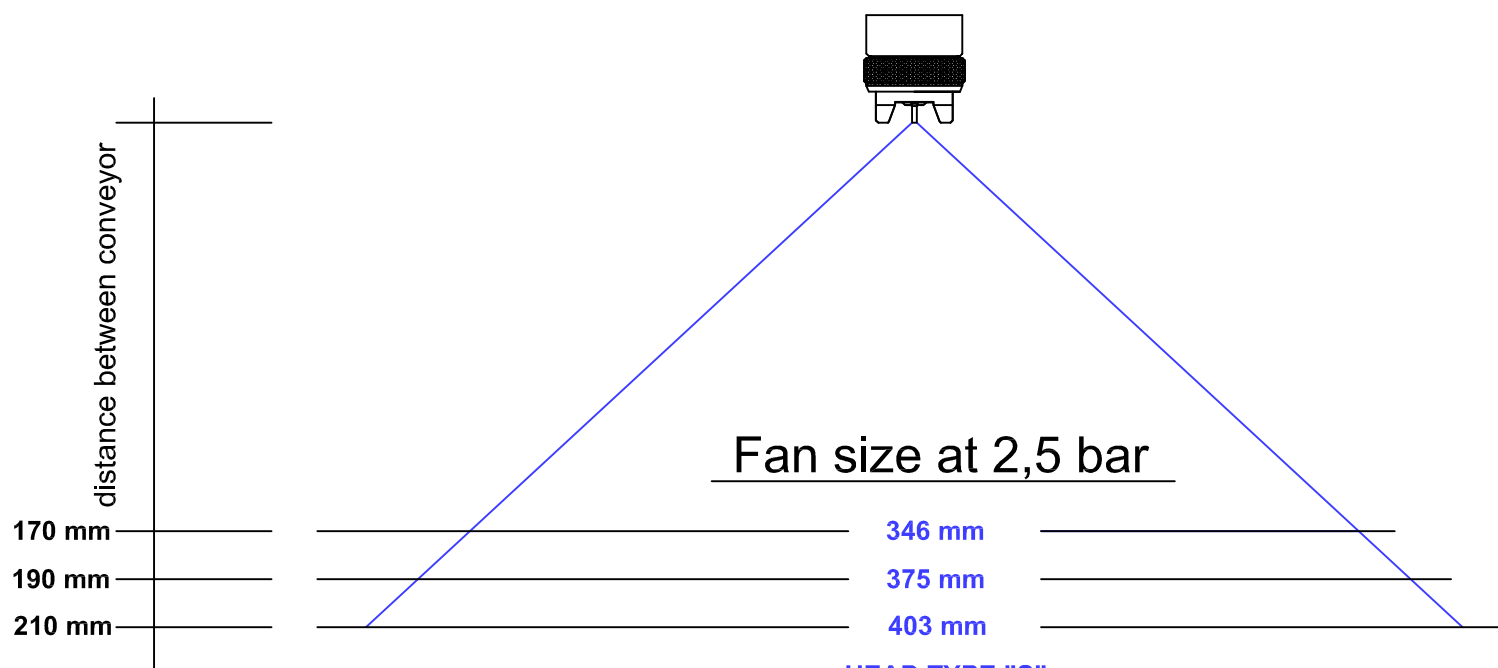
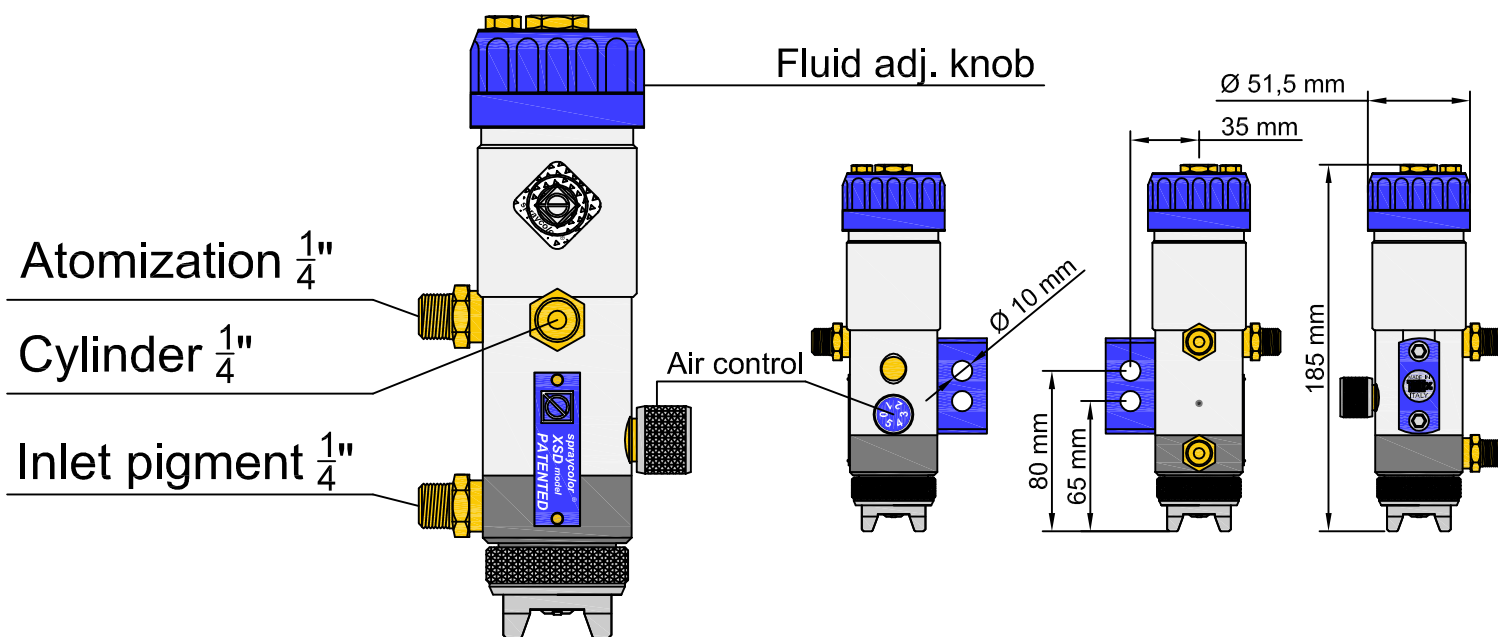

\* Test with water 2,5 bar for atomization  
Pressure pump 0,5 bar  
Size  $\varnothing 1.0$  mm 8 click



---

## ***XSD*** DATASHEET

- softpressure® -

### MODEL

### ***XSD***

TECHNOLOGY	SOFTPRESSURE ®
AIR CONSUMPTION	220 l/min
WEIGHT	1290 gr.
RECOMMENDED AIR CYLINDER	3,5 MAX 4 bar
RECOMMENDED AIR ATOMIZATION	start 2,5 to 3,0 bar MAX
INLET PIGMENT	$\frac{1}{4}$ "
INLET AIR ATOMIZATION	$\frac{1}{4}$ "
INLET AIR CYLINDER	$\frac{1}{4}$ "
RECOMMENDED VISCOSITY	LOW - MEDIUM -
KIT SIZE AVIALE	Ø 0.8 - Ø 1.0 - Ø 1.2 - Ø 1.5 mm -

- ADVANTAGES:**
- 1 Certified UNI EN 13966-1.
  - 2 Colour component 100% stainless steel.
  - 3 Reduced overspray.
  - 4 High finish with softpressure® technology.
  - 5 High reliability.