

SC standard pressure – spare part list

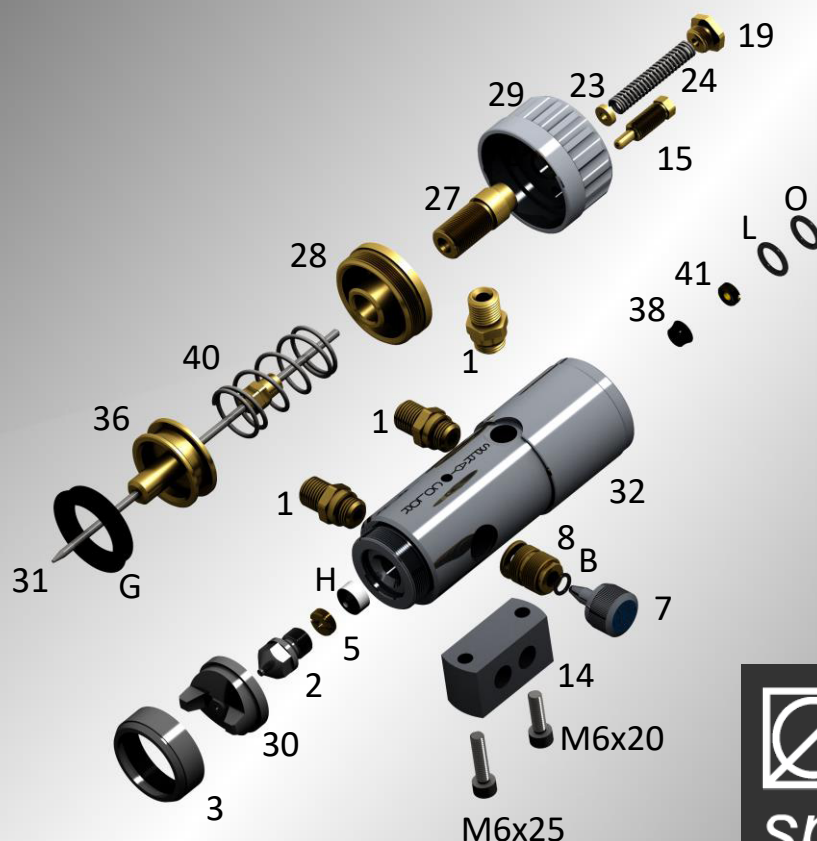

spraycolor®
since **1968**
a family tradition

SCREF 1	pipe fitting G 1/4	SCREF 29/C	complete regulation handwell
SCREF 2	nozzle	SCREF 30	head
SCREF 3	nut for head	SCREF 31	needle
SCREF 5	gasket screw cap	SCREF 32	gun casing
SCREF 7	air regulation screw	SCREF 36	piston
SCREF 8	air regulation valve	SCREF 38	gasket
SCREF 14	support block	SCREF 40	stainless steel piston spring
SCREF 15	release pivot handwell	SCREF 41	screw cap gasket
SCREF 19	cap spring container	SCREF B	O-ring gasket
SCREF 23	washer	SCREF G	gasket
SCREF 24	stainless steel needle spring	SCREF H	gasket
SCREF 27	spring container	SCREF H/2	PTFE special gasket
SCREF 28	cylinder cap	SCREF L	O-ring gasket
SCREF 29	regulation handwell	SCREF O	O-ring gasket



SC

DATASHEET

- standard pressure -

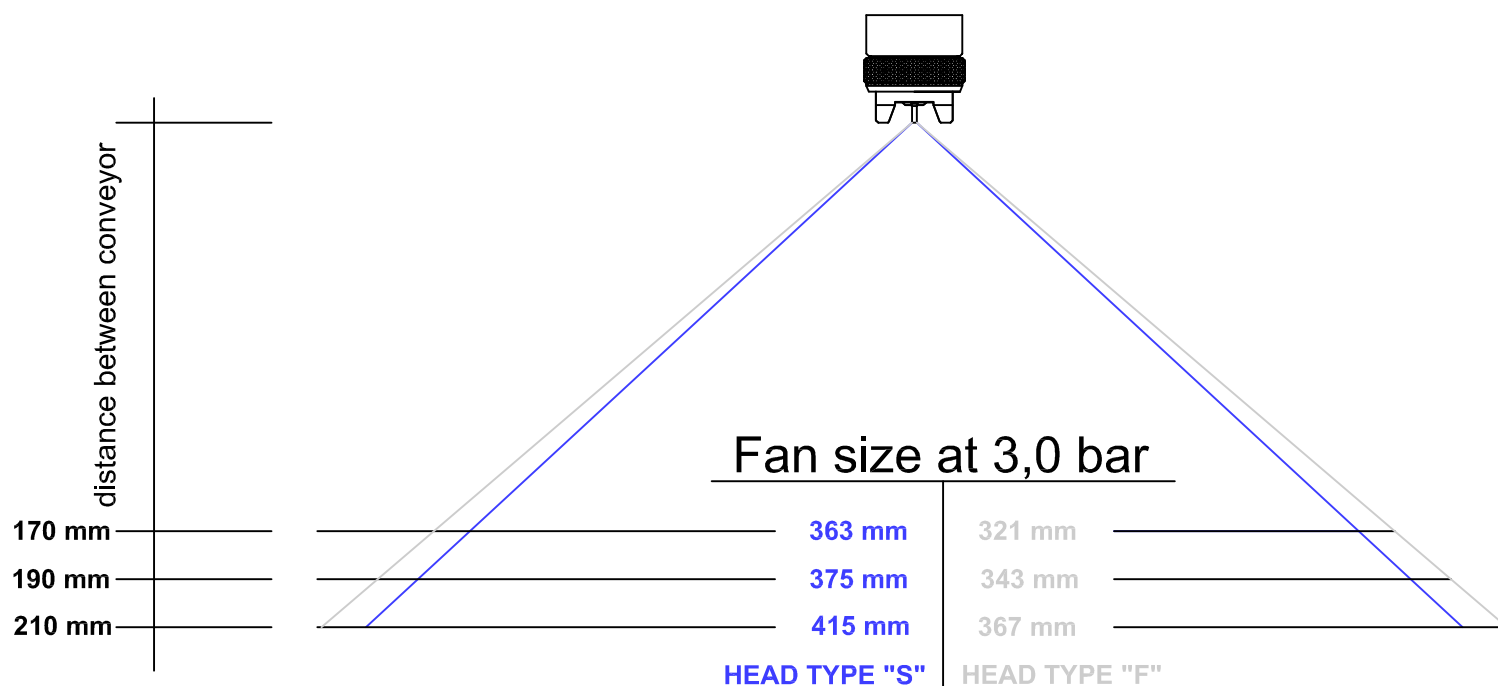
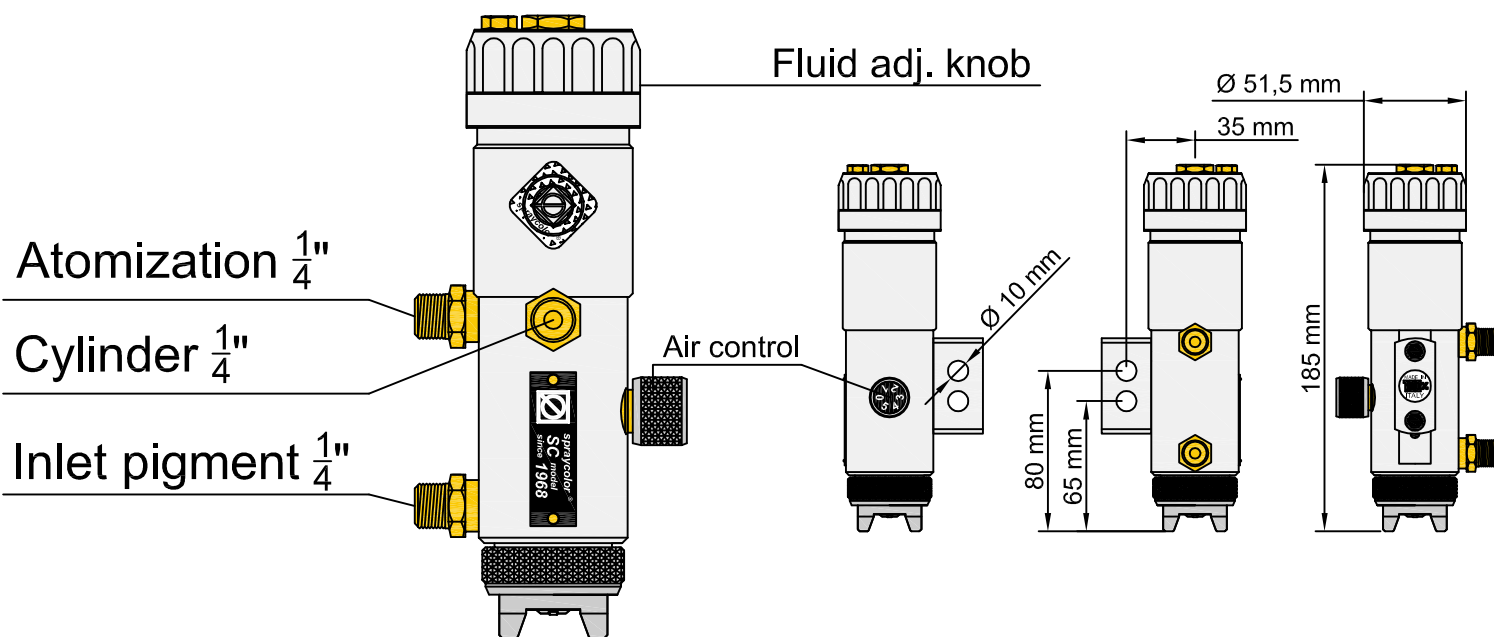

* Test with water 3,0 bar for atomization
Pressure pump 0,5 bar
Size Ø 1.0 mm 8 click



SC

DATASHEET

- standard pressure -**MODEL****SC**

TECHNOLOGY	STANDARD PRESSURE
AIR CONSUMPTION	265 l/min
WEIGHT	1010 gr.
RECOMMENDED AIR CYLINDER	3,5 MAX 4 bar
RECOMMENDED AIR ATOMIZATION	start 3,0 to 4,0 bar MAX
INLET PIGMENT	$\frac{1}{4}$ "
INLET AIR ATOMIZATION	$\frac{1}{4}$ "
INLET AIR CYLINDER	$\frac{1}{4}$ "
RECOMMENDED VISCOSITY	LOW - MEDIUM - HIGH
KIT SIZE AVIABLE	Ø 0.8 - Ø 1.0 - Ø 1.2 - Ø 1.5 mm - Ø 1.7 - Ø 1.9 - Ø 2.2 - Ø 2.5 mm -

ADVANTAGES: 1 Economic.
2 PTFE gaskets.
3 Stainless steel springs.
4 Versatile.
5 High reliability.